

**473nm~480nm 20mW Single Mode Coaxial Package Fiber Coupled Laser Diode Module**
**473nm SM Pigtailed LD with 3um Single Mode Fiber (SM Fiber) | Blue LDM**

WSLP-473-020m-4

Wavespectrum Laser Group

[www.wavespectrum-laser.com](http://www.wavespectrum-laser.com)

<b>473nm Pigtailed Diode Laser</b>	<b>20mW/SMF</b>	<a href="http://en.wavespectrum-laser.com.cn">en.wavespectrum-laser.com.cn</a>
------------------------------------	-----------------	--

PARAMETER	SYMBOL	VALUE	UNIT
Reverse Voltage	$V_r$	2.0	V
Operating Temperature	$T_{op}$	-10~+60	°C
Storage Temperature	$T_{stg}$	-40~+85	°C
Lead soldering temperature (10 sec.)	$T_{is}$	260	°C

**Features:**

- 473nm Diode Laser
- 3um SM Fiber
- Coaxial or B82 Package
- High Stability

**Applications:**

- Medical Laser Treatment
- Biotechnology
- Others

**Specifications**
**WSLP-473-020m-4**

	Min	Type	Max
Center Wavelength@25°C	473nm±10nm		
Spectral Width (FWHM)	----	2.0nm	----
Output Power	----	20mW	----
Fiber Type	Single Mode Fiber		
Fiber Core	3um		
Recommend Operating Temperature	25°C		
Fiber Length	----	80cm	100cm
Threshold Current	----	35mA	65mA
Operating Current	----	140mA	160mA
Operating Voltage	----	6.5V	8.0V
Package Style	Coaxial or B82		
Fiber Connector	FC/SC/SMA905		
Photodiode	Without		

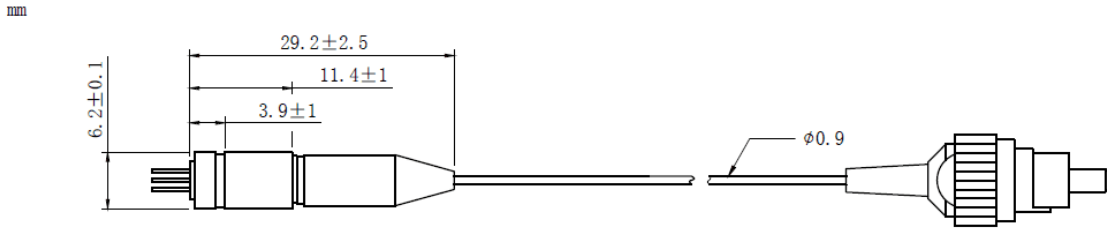

**Coaxial Package View: (Part Number: WSLP-473-020m-4)**

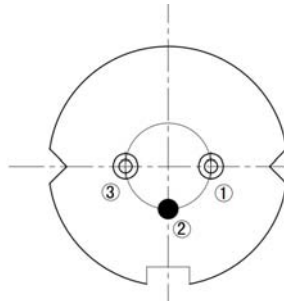
**B82 Package View: (Part Number: WSLP-473-020m-4-B)**

**PIN Bottom View:**

<b>1</b>	<b>LD(+)</b>
<b>2</b>	<b>GND</b>
<b>3</b>	<b>LD(-)</b>



Electrically shorten LD module and store in non-extreme conditions.  
Suggest using the constant current power supply.

