

488nm~492nm 30mW Single Mode Coaxial Package Fiber Coupled Laser Diode Module
485nm~488nm~490nm SM Pigtailed LD with 3um Single Mode Fiber (SM Fiber) | Blue LDM

WSLP-488-030m-4

Wavespectrum Laser Group

www.wavespectrum-laser.com

488nm Pigtailed Diode Laser		30mW/SMF		en.wavespectrum-laser.com.cn	
PARAMETER	SYMBOL	VALUE	UNIT		
Reverse Voltage	V_r	2.0	V		
Operating Temperature	T_{op}	-10~+60	°C		
Storage Temperature	T_{stg}	-40~+85	°C		
Lead soldering temperature (10 sec.)	T_{is}	260	°C		
Features: <ul style="list-style-type: none"> ● 488nm Diode Laser ● 3um SM Fiber ● Coaxial or B82 Package ● High Stability 					
Applications: <ul style="list-style-type: none"> ● Medical Laser Treatment ● Biotechnology ● Others 					
Specifications	WSLP-488-030m-4				
	Min	Type	Max		
Center Wavelength@25°C	480nm	488nm	495nm		
Spectral Width (FWHM)	----	2.0nm	----		
Output Power	----	30mW	----		
Fiber Type	Single Mode Fiber				
Fiber Core	3um				
Recommend Operating Temperature	25°C				
Fiber Length	----	80cm	100cm		
Threshold Current	----	35mA	70mA		
Operating Current	----	150mA	170mA		
Operating Voltage	----	6.5V	8.0V		
Package Style	Coaxial or B82				
Fiber Connector	FC/SC/SMA905				
Photodiode	Without				

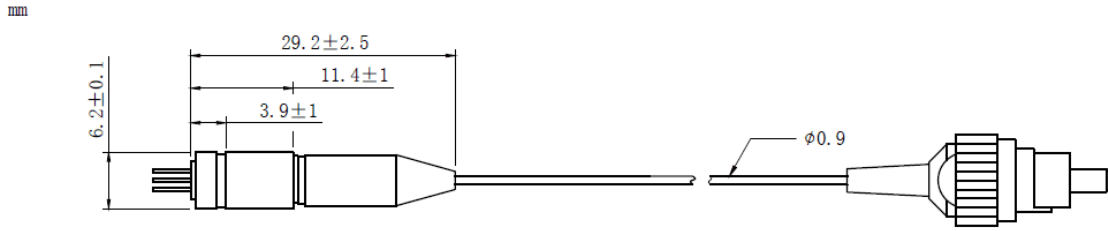
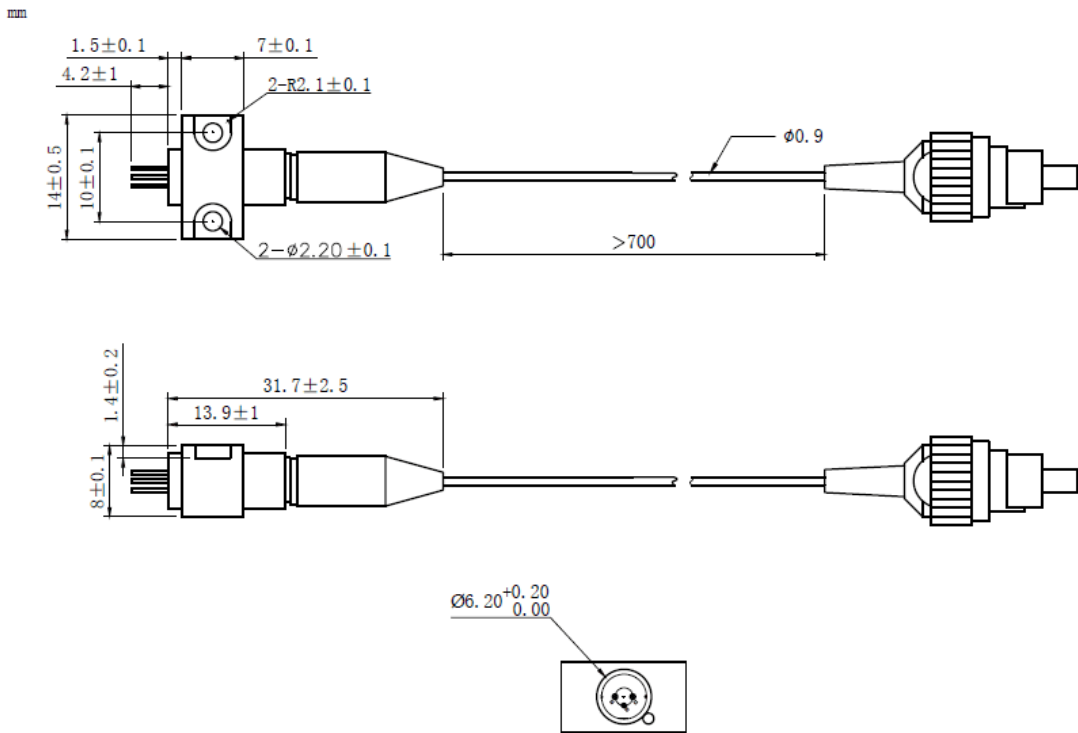
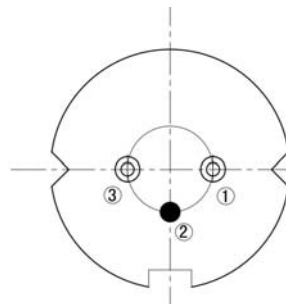

Coaxial Package View: (Part Number: WSLP-488-030m-4)

B82 Package View: (Part Number: WSLP-488-030m-4-B)

PIN Bottom View:

1	LD(+)
2	GND
3	LD(-)



Electrically shorten LD module and store in non-extreme conditions.
Suggest using the constant current power supply.

